

Summary of Proposed Works

- Removal and making good to redundant flue stack
- Removal and making good to leaking wind catches
- Replacement of tiled roof covering with new Sika Sarnafil single ply covering
- Re-instatement of existing roof mounted services
- Replacement / capping of timber fascia's & bargeboards with low-maintenance aluminium to match existing surrounding. Spec TBC.
- Adaptions to above ground rainwater goods in line with roofing works. Scope TBC.
- New clip-on mansafe system to give full protected roof access. Layout and spec TBC.

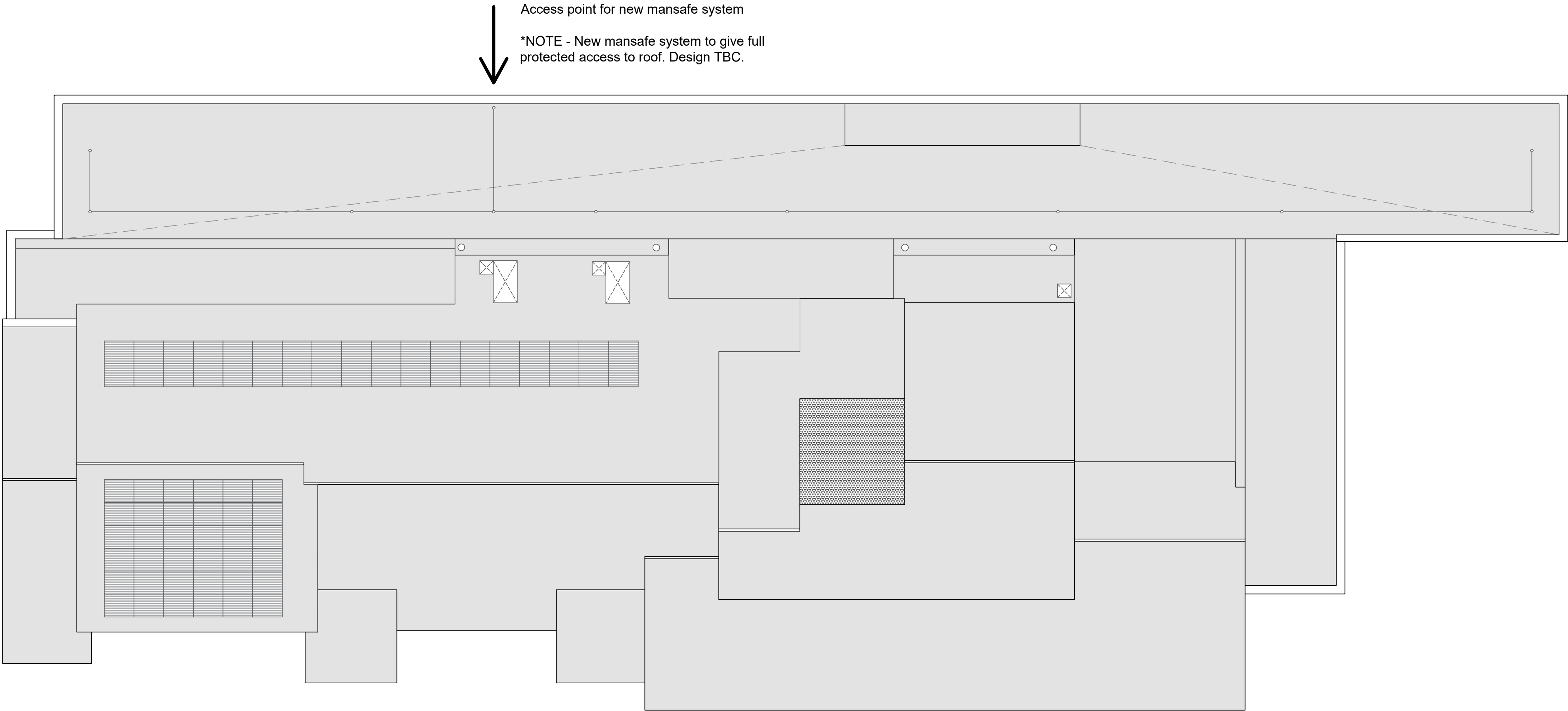
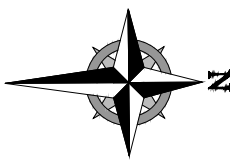
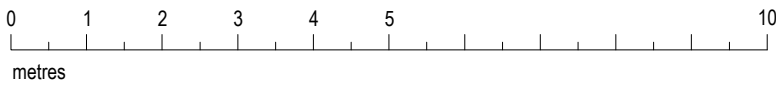

1 Proposed Roof Plan  
1:100

<div>Currie &amp; Brown</div> <div>Poseidon House, Neptune Park, Maxwell Road, Plymouth, PL4 0SN United Kingdom</div> <div>Tel: 01752 273473 Fax: 01752 257755 www.curriebrown.com</div>	
Project St Mary's Airport Roof Replacement Works	
Title Proposed Roof Plan	
Client Council of the Isles of Scilly	
Date 06.06.22	Drawn AH
Scale 1:00 @A1	Checked KC
Drwg No. 4101565-2-04	Rev

Do not scale from this drawing, check all dimensions  
This drawing is copyright